



Bifold Door Installation Instructions

Note: If you encounter any problems with the package and/or the following installation, please email us at info@doubledw.com and include your order id.

Included Parts List:

1. Track - Mill Finish
2. Wood Valance Cover - for front & back of track (1/2" thick 1 1/2" h)
3. Roller/Carrier Assembly
4. Quick Release Plate
5. Pivot Assembly
6. Bi-Fold Aligner
7. Snugger
8. Bi-Fold Hinges
9. #8 x 3/4" PH SMS
10. #8 x 1" PH SMS
11. #8 x 1 3/4" PH SMS
12. #10 x 3/4" FH SMS
13. #8 x 7/8" FH SMS

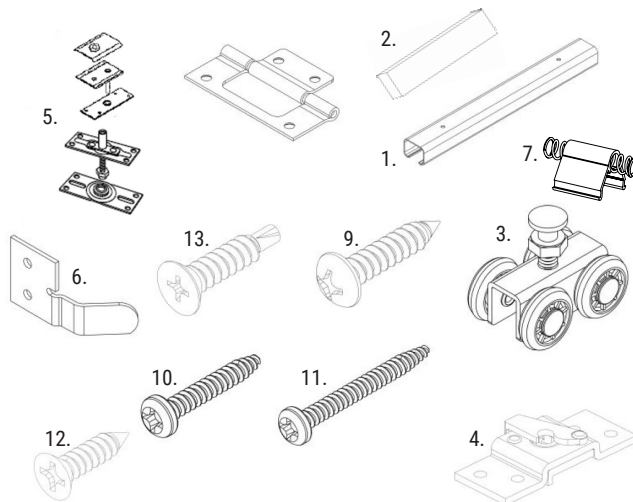

Recommended Tools:

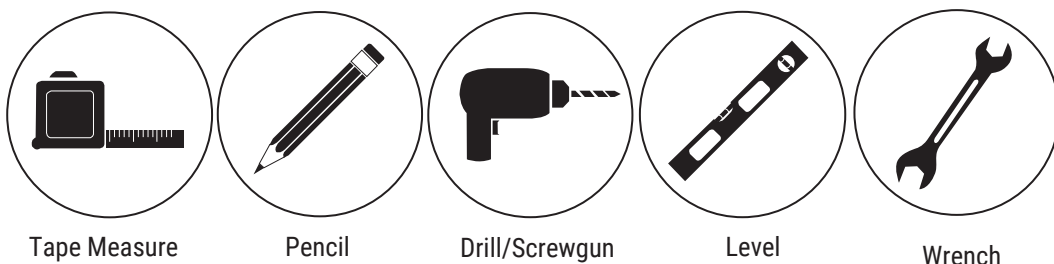

Step 1: Determine Finished Opening Width & Height

- a. Finished Opening Width and Height can be either wood cased opening or drywall wrapped opening.
- b. Finished Opening Width should be checked in three (3) spots - Top, Bottom & Middle. The smallest of the three measurements should be used when ordering.
- c. Finished Opening Height should be checked in three (3) spots - Left, Right & Middle. The smallest of the three measurements should be used when ordering.

*NOTE:

- When ordering DDW needs your FINISHED OPENING WIDTH and HEIGHT, we do all of the deductions internally to ensure proper calculations.
- Bypass doors do NOT come with a handle(s), cased opening or door jamb unless purchased separately.
- 2 track systems require a minimum of a 4-1/2" jamb width and 3 track systems require a minimum of a 6-1/2" jamb width.

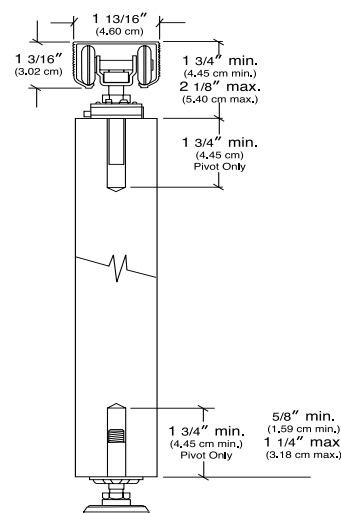

Step 2: Center Hung vs Edge Hung Bifolds

- a. Edge Hung Bifolds
 - i. Door panels MUST remain in EVEN pairs and can open left, right OR left and right.
 - ii. All of the door panels are the same width.
 - iii. All hardware is mounted towards one end of the panels and the rollers are only required on every other panel.
- b. Center Hung Bifolds
 - i. Allows for EVEN or ODD number of door panels opening left, right OR left and right.
 - ii. The first panel is approx. 1/2 the width of the remaining door panels.
 - iii. Pivot hardware is mounted towards one end of the first panel and rollers are placed in the center of all the remaining panels.

Step 3: Bifold Configuration

- a. Bifold Configuration is the number of door panels in a given opening and the direction of movement (opening to) while standing in front of the doors. When open the doors accordion/fold out towards you and stack 90 degrees to the track/opening.

Example: Four (4) Doors Opening Left means four (4) door panels will open from the right to the left and the doors will accordion out towards you and stack 90 degrees to the track/opening on the left side.

***NOTE:** When selecting your bifold configuration the maximum single door panel width is 30" for Edge Hung and 36" for Center Hung. Edge Hung Example: 10' (120") opening width requires at least 4 door panels ($120"/4=30"$)

Step 5: Install Track and Hardware

- Line up track flush against jamb on guide door side for 2-door, center track in opening for 4-door (Track length should be $1/8"$ less than opening width)
- Place Top pivot bracket and hangers loose in track before securing track with (#8 x 1") screws
- Position top pivot bracket center $2\ 1/8"$ from jamb and hand tighten
- Fasten bottom pivot plate to the floor by securing screws in elongated holes ONLY. A temporary distance of $2\ 5/16"$ to the center can be used and later adjusted after the door is in place with (#8 x $3/4"$) screws
- Center quick release and pivot plates on door thickness
- Mount top and bottom pivot plates $2"$ from center to pivot door edge. (Fig 1)
- Mount quick release plate $2"$ from center to guide door edge (Fig 1) *If Center Hung quick release plate should be centered on top of each guide door panel
- Secure plates onto door with (#8 x $1\ 1/2"$) screws
- To install hinges place doors side by side as if folded
- Secure 3-4 hinges per door panel pending height of door panels with (#8 x $7/8"$) screws. (Fig 2)

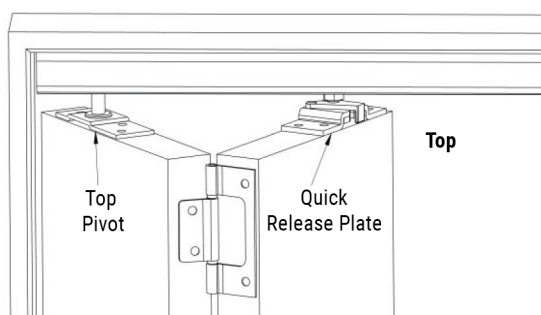
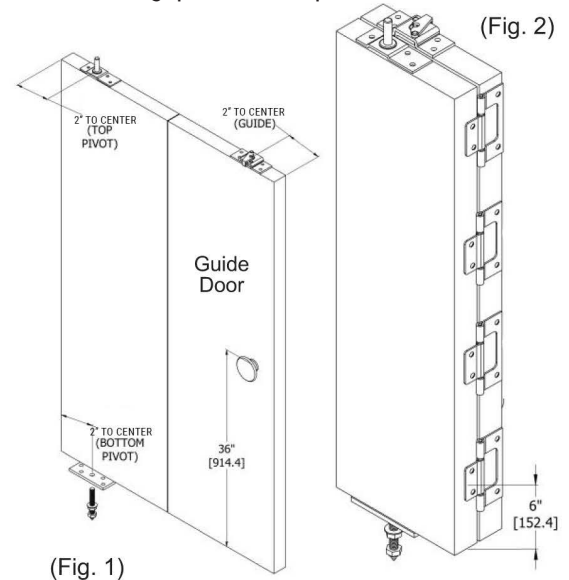
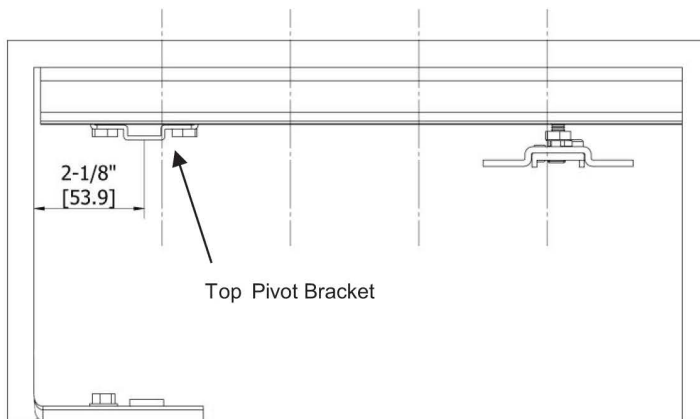

Step 5: Installing Door(s)

- Fold doors together and engage top pivot into top pivot bracket
- Set bottom pivot assembly into the floor $2\ 5/8"$ from the wall
- Slide carrier bolt into quick release mount plate and close latch

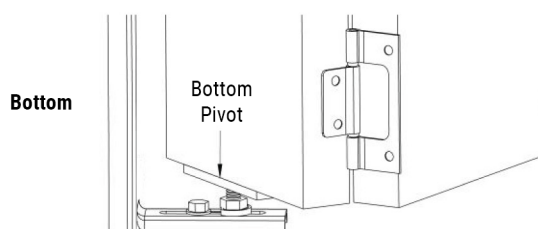

Step 6: Adjust and Finish

- Adjust carriers and pivots so door is square with frame
- Slide jamb bracket carrier in or out to adjust tilt
- Install aligners in back, about 12" from bottom with (#8 x 3/4") screws. (4 door install only)
- Install stops between top guide and side jamb furthest from pivot for 2 doors and in the middle between the two pairs of doors for 4 doors

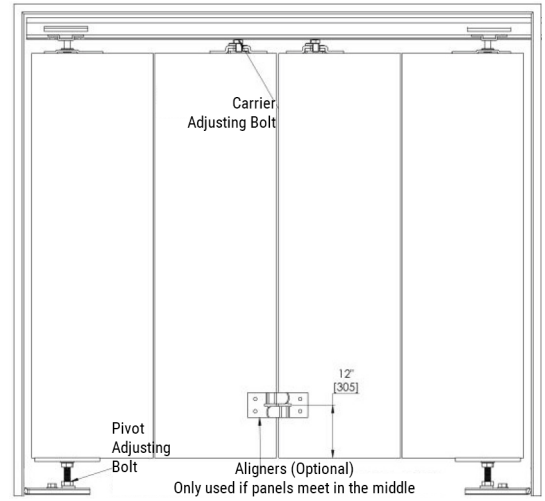

Step 7: Optional Accessories

- a. Snugger - Insert Snugger guide into the track at the end of the track that the doors close against (For any of the x left and x right configurations place one (1) Snugger in the middle where the doors come together).
- b. Valance/Track Cover - We supply enough wooden track cover (1/2" thick x 1 1/2" tall) to be placed in front of and behind the track once the unit is fully installed. Simply place double sided tape (*NOT Supplied*) on the face of the track and then press the track cover on (*Once cut to fit and painted/stained*).



WARNING

- Failure to wear proper safety gear (i.e., eye protection) may result in serious injury or death. Always wear proper safety gear before using power tools.
- Improper operation of power tools may result in loss of control, serious injury or death. Always ensure you have complete control of the power tool and the work area is free of hazards before operating a power tool.
- Lack of secure clamping of the door may result in unexpected movement of the door, loss of power tool control and serious injury or death. Always securely clamp the door in place before cutting, or drilling, the door.
- Lack of, or improperly installed tracks, wheeled hanger/roller assemblies or floor guides may result in the door coming out of the track and cause serious injury or death.



CAUTION

- Mishandling of heavy objects (i.e., doors) may cause a loss of balance and serious injury. Always be sure you have a secure hold on the object and are balanced before moving the object. Always wear safety shoes when lifting heavy objects.
- Getting body parts (i.e., hair, fingers) caught in moving parts may cause pinching and serious injury. Do not put fingers in parts that may move and always remove or contain anything on your body that may become entangled with a moving part.
- Closing bifold/sliding doors with your hand on the end of the door may result in your hand, or fingers, getting caught between the door and other solid objects (i.e., another door, molding) causing serious injury. Always use a door handle to close doors.

Usage Statement:

Use of excessive force when opening, and closing, the door(s) may result in damage to the hardware.



* For more information visit the DDW website at: www.doubledw.com or call 716.202.8560
Specifications are subject to change. Confirm with Dalmatian Doors and Woodworking before ordering.